

Table 18.1 Agricultural Land Sales

Sale	Price	Acres	Price per Acre
1	\$400,000	70	\$5,714
2	\$500,000	90	\$5,556
3	\$550,000	103	\$5,340
4	\$600,000	110	\$5,455
5	\$700,000	135	\$5,185
6	\$775,000	150	\$5,167
7	\$805,233	155	\$5,195
8	\$896,543	175	\$5,123
9	\$985,700	195	\$5,055
10	\$1,000,000	200	\$5,000
11	\$1,256,500	230	\$5,463
12	\$1,125,890	250	\$4,504
13	\$1,258,900	285	\$4,417
14	\$1,358,000	310	\$4,381
15	\$1,580,000	366	\$4,317

Figure 18.1 Price per Acre

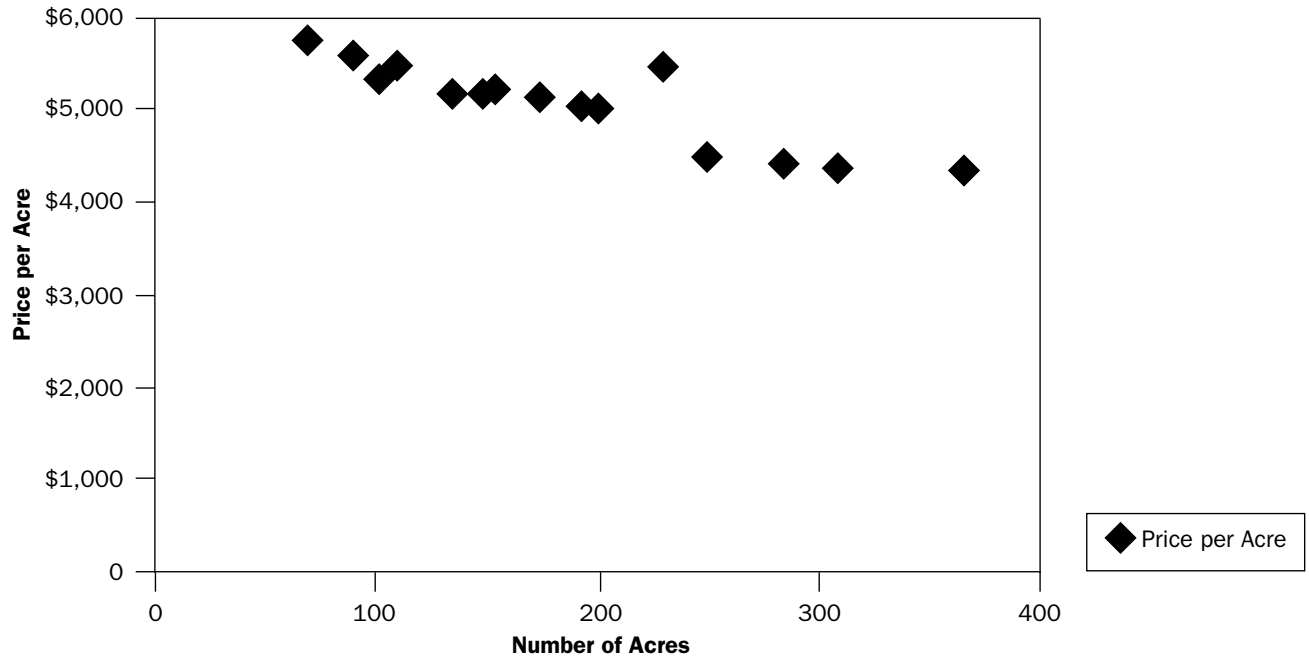

Table 18.2 Ranking Analysis

Address	Bdr.	Bath (F/H)	Legal	Acre	Garage	Levels	Bsmt.	Fin. Bsmt.	GLA sq. ft.	Price	\$ per sq. ft.
1 773 Coventry Way	5	2/1	Brookshire	0.35	3-car att.	2	yes	yes	2,540	245,000	96.46
2 2429 Windsor Drive	4	2/2	Brookshire	0.38	3-car att.	2	yes	yes	2,584	242,500	93.85
3 2795 Brookshire Parkway	4	3/2	Brookshire	0.35	2-car att.	2	yes	yes	2,254	234,900	104.21
4 2207 Windsor Drive	4	2/1	Brookshire	0.35	3-car att.	2	yes	no	2,677	220,000	82.18
5 888 Duchess Drive	4	3/2	Brookshire	0.38	2-car att.	2	yes	no	2,268	217,500	95.90
6 890 Windsor Drive	3	2/1	Brookshire	0.30	2-car att.	2	yes	no	2,612	200,000	76.57
7 895 Brookshire Court	4	3/2	Brookshire	0.25	2-car att.	2	no	no	2,429	191,000	78.63
8 795 Kent Parkway	4	2/1	Brookshire	0.28	2-car att.	2	no	no	2,156	179,900	83.44
9 795 Hampshire Drive	2	2/1	Brookshire	0.23	2-car att.	1	no	no	2,122	178,000	83.88
10 695 Brookshire Parkway	3	2/1	Brookshire	0.22	2-car att.	1	no	no	1,822	170,000	93.30
11 555 Brookshire Parkway	3	3/2	Brookshire	0.21	2-car att.	1	no	no	2,016	167,500	83.09